

ALFA420H-2



Professional humidified, convection oven in stainless steel, 4 trays 600x400mm or GN1/1

Product Family	Ovens
Type	Convection Ovens
Range	4 trays 600x400mm
Line	4 trays 600x400mm

TECHNICAL SHEET

TECHNICAL DATA

electromechanical: electromechanical

4 trays: 4 trays

230V 1N 50Hz / 2.2 kW - single phase 10 amp: 400V 3N 50Hz / 6.9 kW; 230V 1N 50Hz / 6,9 kW

602x584x537 mm: 800x747x563 mm

80mm: 80mm

: direct, with 3 levels of automatic humidity selectable in addition to manual adjustment

50 - 250°C: 50 - 280°C

0 - 60' / Manual: 1 - 99' / Manual

1: 1

enamelled: enamelled

tilting opening door: tilting opening door

: 435x320mm

: electrical

: Convection; Convection + Humidification
: stainless steel

ACCESSORIES

- [3729](#) - 4 chromed wire grids kit, 441x340mm
 - [3735](#) - 4 chromed wire waved grids kit, 435x320mm
 - [3820](#) - Kit of 4 trays made of aluminized sheet, 435x320mm
 - [3755](#) - 4 perforated aluminium trays kit, 435x320mm
 - [3780](#) - Kit of 4 nonstick trays, 435x320mm
 - [TVL40](#) - Frame stand in stainless steel with tarys guide, for oven series ALFA43
- 4730
- [3926](#) - Air flow reduction kit (1 pc), for ovens series ALFA43, ALFA45

Do you need more information about this product? Contact us and we will reply to you as soon as possible.

[CONTACT US](#)

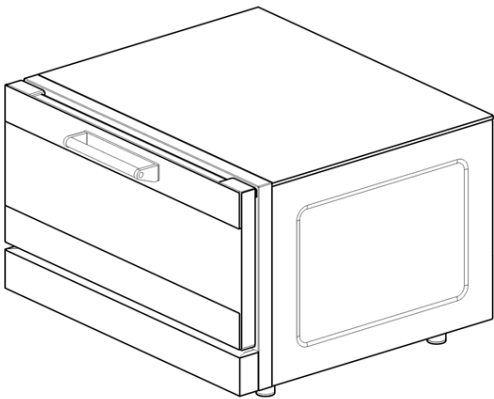
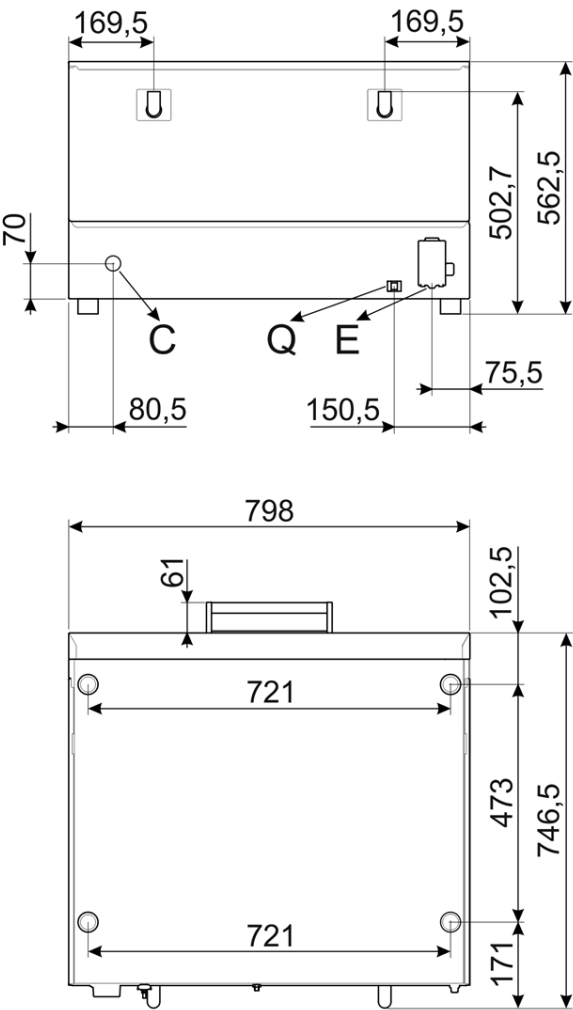

Q	MORSETTO EQUIPOTENZIALE EARTH TERMINAL
E	CAVO ALIMENTAZIONE ELETTRICA ELECTRICITY SUPPLY CABLE
C	TUBO DI CARICO (solo su alcuni modelli) FILLER HOSE (on some models only)