

XP

Economy Passthrough Dishwasher

W 730mm x D 720mm x H 1530mm

Washtech's XP is a versatile, highly efficient, simple-to-use and easy-to-maintain passthrough dishwasher. With one of the industry's lowest water consumption rates along with leading rinse heating, the XP provides excellent wash results in less time, while being light on operating costs and the environment.

The XP features Washtech Hybrid Controls which combine IP65 stainless switches, tried-and-tested switchgear, with a customisable electronic timer.

Since 1981 Washtech dishwashers have been constructed from heavy-duty stainless steel, and are engineered specifically for Australian conditions and regulations. Backed by the most extensive service network and spare parts inventory in the region, your Washtech dishwasher will not let you down.

Standard Features

- Autostart on hood closure 1, 2 and 3 minute wash cycles
- Washes up to 1,080 plates per hour/1,500 glasses per hour
- Low hot water consumption of 2.2 litres per cycle
- Washtech Hybrid Controls
- Self-cleaning cycle
- Easy Installation supplied complete with:
 - Water supply hose
 - Detergent and rinse aid pumps with injector lines
 - 15 amp plugset
 - No commissioning required
- Heavy-duty stainless steel construction and wash manifold
- Upper and lower wash/rinse arms with precision moulded jets
- Double heavy duty stainless steel filtration system including dual scrap trays and separate wash inlet filter
- Watermark approved backflow prevention
- Comprehensive 5-2-1 warranty

Includes:

- 1 x 500mm dish rack (600 70028)
- 1 x 500mm cup rack (600 70029)
- 1 x cutlery container (C660503)

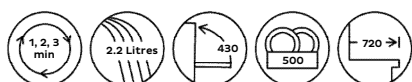

XP

Economy Passthrough Dishwasher

W 730mm x D 720mm x H 1530mm

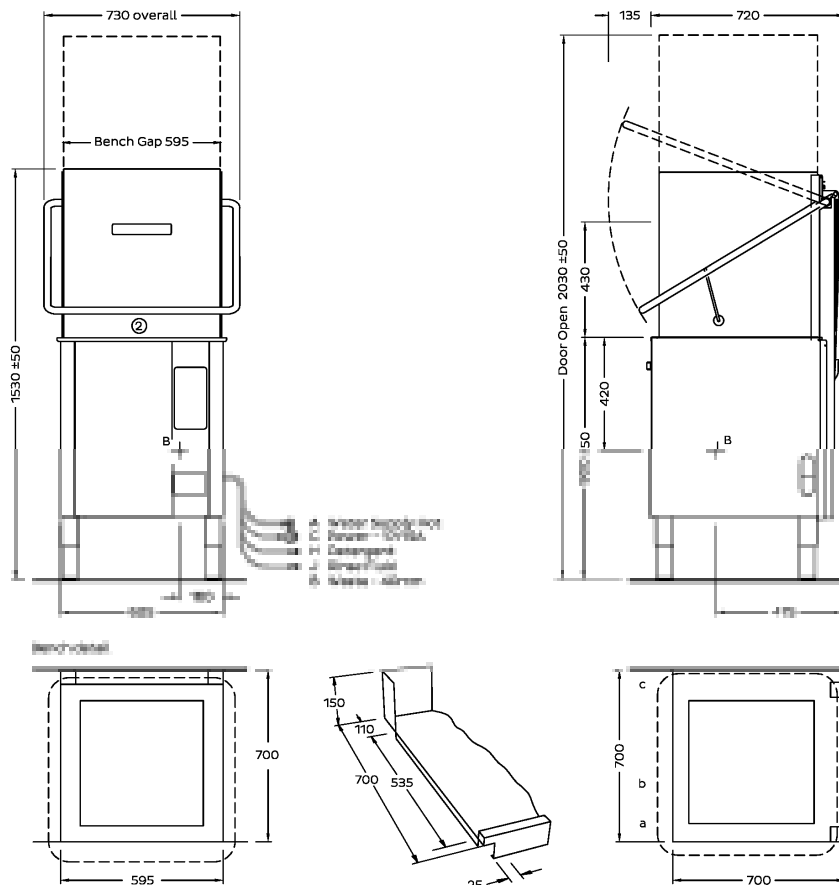

MOFFAT
moffat.com.au

Australia
Moffat Pty Limited

Victoria/Tasmania
740 Springvale Road
Mulgrave, Victoria 3170
Telephone 03-9518 3888
Facsimile 03-9158 3833
vsales@moffat.com.au

New South Wales
Telephone 02-8833 4111
nswsales@moffat.com.au

South Australia
Telephone 03-9518 3888
vsales@moffat.com.au

Queensland
Telephone 07-3630 8600
qldsals@moffat.com.au

Western Australia
Telephone 08-9202 6820
wasales@moffat.com.au

A Hot water	
Temperature	65°C
Connection	3/4" male; hose supplied
Pressure	200-350kPa
Flow	20 litres per min
Quality	Potable - refer table
Backflow Prevention	Atmospheric Vacuum Breaker
Consumption	2.2 litres per cycle*

B Waste	
Connection	1.5" BSP
Line	2" BSP

C Electrical		V	Hz	A/phase	max kW
Single Phase		240	50	15	3.75
Three Phase		415	50	15	9.00

Corner Installation Notes:

- Machine must face left for easy access to controls
- Allow 300 clearance to front for service access
- Splashback return must be no higher than 150

Refer operator manual for installation instructions. Isolating switch must be within 1m of, and not directly behind the machine.

*Consumption may vary with site conditions.

Dimensions		Machine	Packed
Width		730	760
Depth		720	830
Height		1530	1450
Weight		94	125
Cubicmetres			0.91

Water Quality		Min	Max
pH		7	8
Hardness ppm		20	100
Cl ⁻			100
SO ₄			400
Fe			0.1
Mn			0.5
Cu			0.05
Cl ₂			0.1



ISO9001
All Washtech products are designed and manufactured by Washtech using the internationally recognised ISO9001 quality management system, covering design, manufacture and final inspection, ensuring consistent high quality at all times.

In line with policy to continually develop and improve its products, Washtech reserves the right to change specifications and design without notice.



© Copyright Moffat Ltd
Version: 1903

an Ali Group Company



The Spirit of Excellence